

Global Real Estate Summit 2019

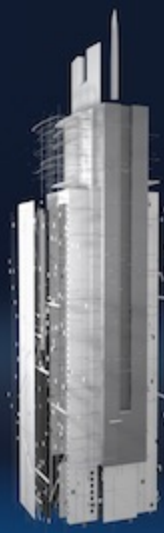

Susan Swanezy

Partner

Hodes Weill & Associates

Susan Swanezy is a Partner of Hodes Weill, responsible for coverage of institutional investors and consultants in North America. Ms. Swanezy coordinates Hodes Weill's Marketing and Distribution efforts globally and is active in the origination of new business and advising clients. Ms. Swanezy is a member of Hodes Weill's Operating Committee. Ms. Swanezy has over 30 years of real estate experience, originally as real estate finance banker and then turning to real estate investment management in 2001. Previously, Ms. Swanezy was a Managing Director and Head of Distribution for Credit Suisse's Real Estate Investments Group. Prior to joining Credit Suisse, Ms. Swanezy was a Managing Director at Stockbridge Capital Partners, focused on client relations and business development. From 2002 to 2007, Ms. Swanezy was a Partner in Deutsche Bank RREEF's Client Relations Group, where she worked with institutional investors across a variety of real estate investment strategies and vehicles. Until 2001, Ms. Swanezy was an investment banker with Deutsche Bank's real estate investment banking group, the successor entity to BT Alex Brown, providing both public and private debt and equity related products to REITs, private real estate operators and real estate funds. Ms. Swanezy is a current member of PREA, ULI and WX Women Executives in Real Estate where she was the former President and was honored as WX Woman of the Year in 2014. Ms. Swanezy serves on the Board of Directors of AvalonBay Communities, Inc. (NYSE: AVB). Ms. Swanezy received a BS degree from the School of Foreign Service (SFS), Georgetown University and currently serves on SFS's Board of Advisors.